

10' x 20' Meeting Room Package

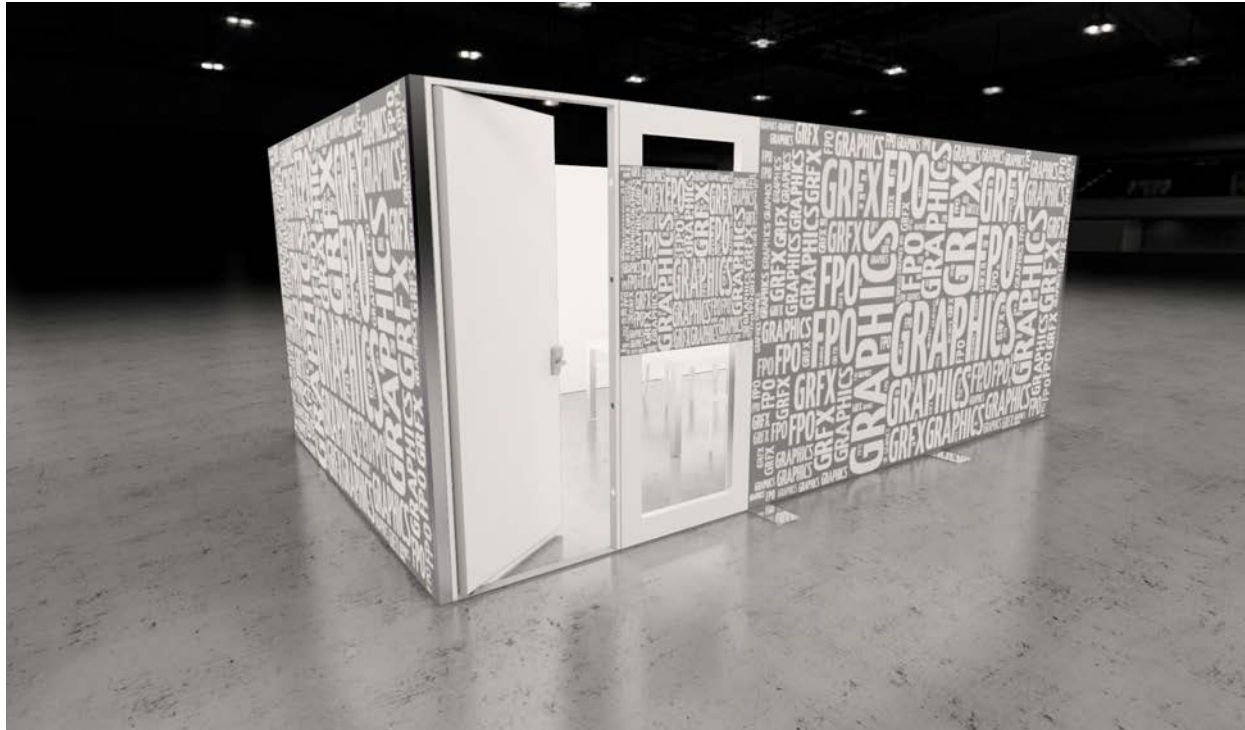

Your Package Includes:

- (1) 3.5M x 5M x 8' Meeting Room with Exterior Fabric Graphics
- (10) Razor Chairs (White)
- (4) Ventura Communal Coffee Table (White)
- (1) Naples Loveseat - (Black)
- (1) Mesa End Table (Black)
- (1) Corrugated Wastebasket
- (1) 12' x 20' Blue Carpet

Important Notes:

- No substitutions are permitted; changes and additions are at Exhibitor expense and can be ordered visiting Freeman Online.
- No additional items may be attached to freeman structure, please contact Brittany O'Briant to add a monitor.
- If carpet color is not selected by 08/24/2026, we will provide gray carpet.
- Please reference [this flyer](#) for Electrical and Internet Services.

10' x 20' Meeting Room Package

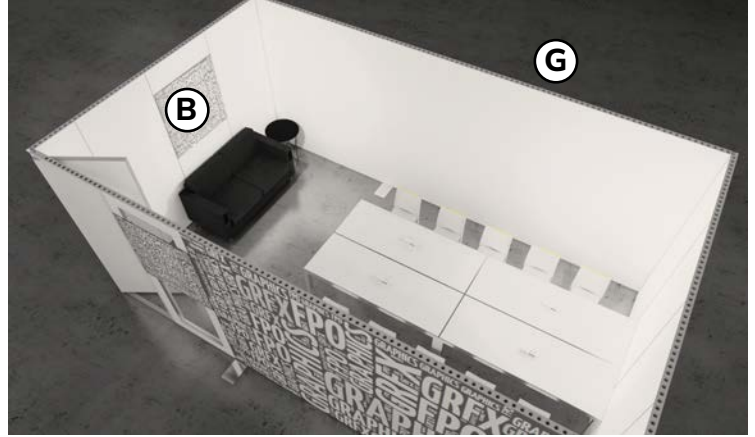
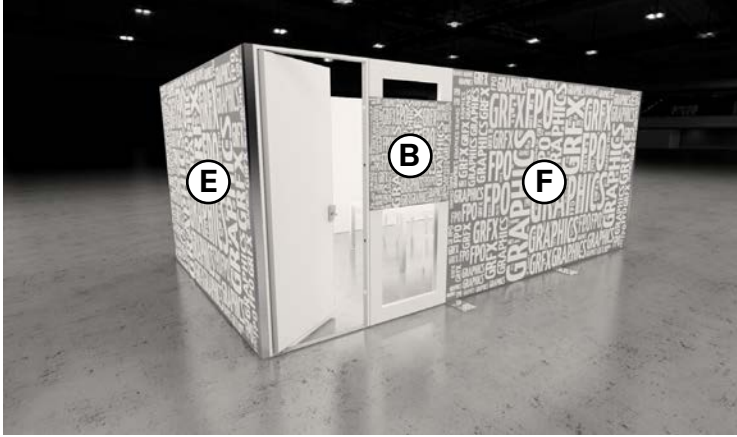

Graphic Panels Included with Your Package:

(B) Interior and Exterior Overlay Panels
(2) 39" x 39"

(G) Exterior Back Wall
234.312" x 95.188"

(E) Exterior Side Wall
(2) 136.688" x 95.188"

(F) Exterior Front Wall
156.25" x 95.188"

Important Notes:

- If your artwork is not received by 08/28/2026, we will print your company logo on each panel.
- Packages purchased after 08/31/2026 will have (3) business days to submit artwork.
- Please name your files with your Company Name, Graphic Panel Names, and Upload Date (XYZCo_C3_8-17).
- [Click here](#) to view production drawings and download graphic templates.

10' x 20' Meeting Room Package

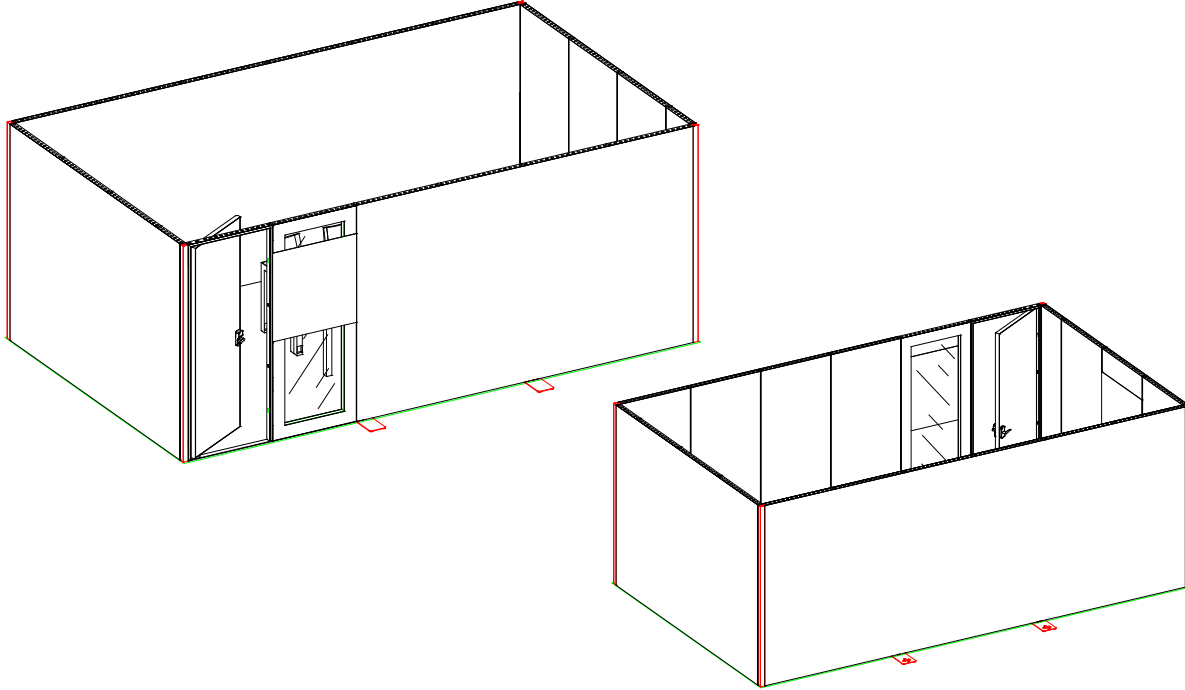

3D View

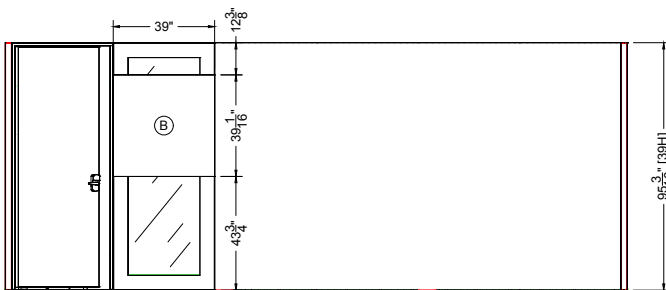

Front Elevation

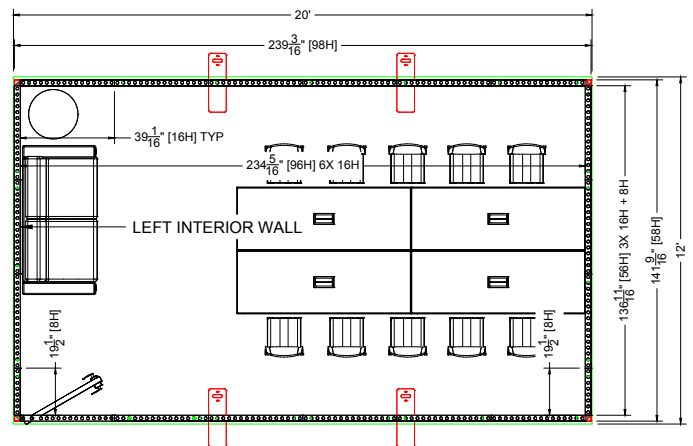

Electrical - Top View

- Please name your files with your Company Name, Graphic Panel Names, and Upload Date (XYZCo_C3_8-17).
- [Click here](#) to view production drawings and download graphic templates.



Meeting Room Packages

PLEASE PROVIDE THE FOLLOWING WHEN SUBMITTING ART

RASTER ART (photos, logos containing any continuous tone images):

- Art submitted at 1:1 (100%), resolution should be no less than 60 dpi (100 dpi preferred)
- Art submitted at 2:1 (50%), resolution should be no less than 120 dpi (200 dpi preferred)
- Art submitted at 4:1 (25%), resolution should be no less than 240 dpi (400 dpi preferred)
- **Files must be 200MB or smaller. Scale large files down as needed.**

VECTOR ART:

- Logos should be vector and have outlined fonts (if provided as bitmap, please use high-res images) **FONTS** and **LINKS**
- Supply all fonts used in your design (zip Mac fonts). If unsure how to collect fonts, convert them to outlines
- Supply all links used in your document. Use packaging feature if available. If unsure how to collect links, embed them in the file when saving.

COLOR:

- If PMS color matching is required, please use original Pantone + Solid Coated swatches in your artwork. Modifying Pantone names will result in printing default color (CMYK)
- CMYK artwork will be produced "As Is". Our color output is balanced and vibrant.
- Convert RGB art to CMYK if possible.
- If you are sending Certified Color Proofs (Gracol, Swop, Fogra), please provide ICC file information used to print your samples. Best option would be to include ICC chart on your prints.

ACCEPTABLE FILE SOFTWARE

We can work with both PC and MAC based software, and can accept art created with the ADOBE Creative Suite - Illustrator, InDesign and Photoshop

Always provide the following:

- Native files with fonts and links (zipped)
- High-res PDF-X/4 exports of the files"

ACCEPTABLE FILE TYPES and SUPPORT FILES

NATIVE FILES:

- AI CLOUD (CC) file with Packaged supporting links and fonts. You may keep images linked but Packaging feature must be used.
- AI (CS6, CS5, CS4...) file with embedded links and outlined fonts
- EPS file with embedded links and outlined fonts
- INDD file with Packaged supporting links and fonts

PRINT FILES:

- High-res PDF-X/4 (preferred)
- AI with PDF content (choose this option when saving file)
- EPS files with embedded links and outlined fonts

RASTER OR BITMAP ART:

- Photoshop EPS (preferred, use 8-bit preview, Max, Quality JPG compression)
- PSD (make sure font layers are rasterized)
- TIFF, JPG (quality 8 and higher)